

**Legend**

- Monitoring Well
- Monitoring Well (Destroyed)
- Overburden Extraction Well Installed in September 2016
- Surface Water Sample Location
- Active Public Water Supply Well
- Assabet River Stage Elevation Location
- Surface Water
- Site Boundary
- Transducer and Manual GWE Measurement Location
- Manual GWE Measurement Location
- Overburden Monitoring Well
- Bedrock Monitoring Well

**Notes:**

- All monitoring wells in each location circled for manual water levels should be gauged.
- Specific wells to be monitored using transducers are designated with an asterisk and presented in Table 7-1.
- The schedule for water level monitored is presented in the text in section 7.2.

**Hydraulic Monitoring Plan - Water Level Gauging**  
 NTCRA Temporary Groundwater Capture System - 100% Design  
 Nuclear Metals, Inc. Superfund Site  
 Concord, Massachusetts

**DRAFT**

**Geosyntec** consultants  
*de maximis, inc.*

Figure  
 7-1

Acton, Massachusetts      MARCH 2017

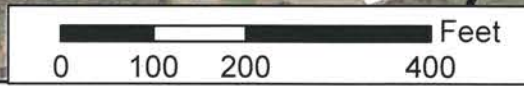

16 Knox Trail Solar Site 10/20/17

**RECORD OWNER**

ASSABET SAND, LLC  
16 KNOX TRAIL  
ACTON, MA

**REFERENCE**

MIDDLESEX REGISTRY OF DEEDS  
SOUTH DISTRICT  
DEED BOOK 48385 PAGE 287  
PLAN No. 1339 OF 2006

TOWN ATLAS - ACTON, MASSACHUSETTS  
MAP J-3 PARCEL 34-5

**DATUM**

N.G.V.D. OF 1929

**REFERENCE**

ASSABET SAND & GRAVEL EPA SITE MAP  
16 KNOX TRAIL, ACTON, MA 01720  
SWPPP CONTACT: DOUG MACONE (978) 897-7661

**LEGEND:**

- N/F NOW OR FORMERLY OVERHEAD WIRES
- TREE TREE
- UP UTILITY POLE
- GG\* GAS GATE
- G GAS SERVICE (BURIED)
- WG\* WATER GATE
- W WATER SERVICE (BURIED)
- DMH DRAIN MANHOLE
- D SUB-SURFACE DRAIN LINE
- EXISTING CONTOUR
- EXISTING CONTOUR
- LIGHTPOLE
- WF# WETLAND FLAG
- RF# RIVERFRONT FLAG
- 99X9 SPOT ELEVATION
- STONE WALL

**MAP NOTES:**

1. 5.1.3.2; POLLUTANTS. - THE STORAGE LOCATION OF ALL POLLUTANT CONSTITUENTS SUCH AS OIL AND CLEANING SOLVENTS ASSOCIATED WITH ALL ON-SITE ACTIVITIES IS INSIDE THE EXISTING MAINTENANCE GARAGE.
2. ALLOWABLE NON-STORMWATER DISCHARGES WHICH ARE AUTHORIZED UNDER THIS MSGP ARE LISTED IN PART 1.1.3 OF THE MSGP.
3. THERE ARE NO ON-SITE DIESEL FUEL STORAGE TANKS. AN OFF-SITE TRUCK DELIVERS FUEL DIRECTLY TO EQUIPMENT ON AN AS NEEDED BASIS. MACHINERY IS PRIMARILY STORED EACH NIGHT ALONG FENCE LINE WITHIN DESIGNATED GRAVEL AREAS.
4. THERE ARE NO OBSERVABLE RUN-ON TO THIS SITE FROM ADJACENT PROPERTIES THAT COULD CONTAIN SIGNIFICANT QUANTITIES OF POLLUTANTS OTHER THAN POSSIBLE SANDS AND TSS FROM ABUTTING SNOW STORAGE AREAS ALONG SOUTHERN PERIMETER.
5. LOCATIONS ON FACILITY ADJACENT TO THE OUTFALL POINTS MAY BE SUBJECT TO ADDITIONAL STORMWATER CONTROLS WHICH ARE TO BE DEVELOPED AND INCORPORATED AS PART OF THIS ONGOING STORMWATER POLLUTION PREVENTION PLAN. SAID WORK IF DEEMED NECESSARY FOLLOWING BENCHMARK MONITORING IS SUBJECT TO ADDITIONAL REVIEW AND PERMITTING BY LOCAL APPROVING AUTHORITIES PRIOR TO INCORPORATION INCLUDING COMPLIANCE WITH PART 1.1.4.5 AND PART 1.1.4.6 OF THE U.S. EPA NPDES MSGP FOR STORMWATER DISCHARGES ASSOCIATED WITH INDUSTRIAL ACTIVITY (MSGP) AS MODIFIED EFFECTIVE MAY 27, 2009.
6. ASSABET RIVER IMPAIRMENTS: PHOSPHORUS (TMDL ESTABLISHED) & E-coli.

- Acronym List:**
- SD Storm Drain
  - DI Drop Inlet
  - DMH Drain Manhole
  - SWC Solid Waste Can (General Location)
  - WOT Waste Oil Tank
  - ETS Empty Tank Storage
  - AST Above Ground Storage Tank
  - MS4 Municipal Separate Storm Sewer System

- Authorized Non-Stormwater Discharges:**
- HPR Hot Water Heater Pressure Relief Pipe (potable water)
  - AC Air Conditioning Condensate
  - FS Fire Suppression System Test Discharge (potable water)

Potential Pollutant Source	Potential Pollutants:
Vehicle and Equipment Maintenance Garage	Fuel, oil, antifreeze, grease, hydraulic fluid, brake fluid, solvents, transmission fluid, parts washer and paint
Electric Pump House	Grease
Electric Feed Hopper	Grease
Electric Primary Crusher	Grease
Electric Wash Sand Processing Plant	Grease
Secondary Crusher	Gear oil, grease
Mobile Screening Plant	Hydraulic fluid, oil, grease, fuel
Mobile Crusher Plant	Hydraulic fluid, oil, grease, fuel
Truck Scale	
WOT: Waste Oil Tank	Aboveground waste oil tank and waste filters are located inside maintenance garage within concrete containment area.
HOT: Heating Oil Tank	Aboveground heating oil tank for furnace is located inside maintenance garage within concrete containment area. Fill pipe and vent on adjacent wall.
ETS: Empty Tank Storage	Residual oil, lubricants, hydraulic oil
SWC: Solid Waste Can	
AST: Above Ground Storage Tank	Storage tanks are all located inside garage and within oil containment area.
SDS: Private on-site subsurface Sewage Disposal System	Restricted to employee bathroom use only.
Truck Parking	Oil, grease, fuel

Impervious Surface Estimate  
(% of total facility area): 3%  
Total Facility Size (acres): 6.84

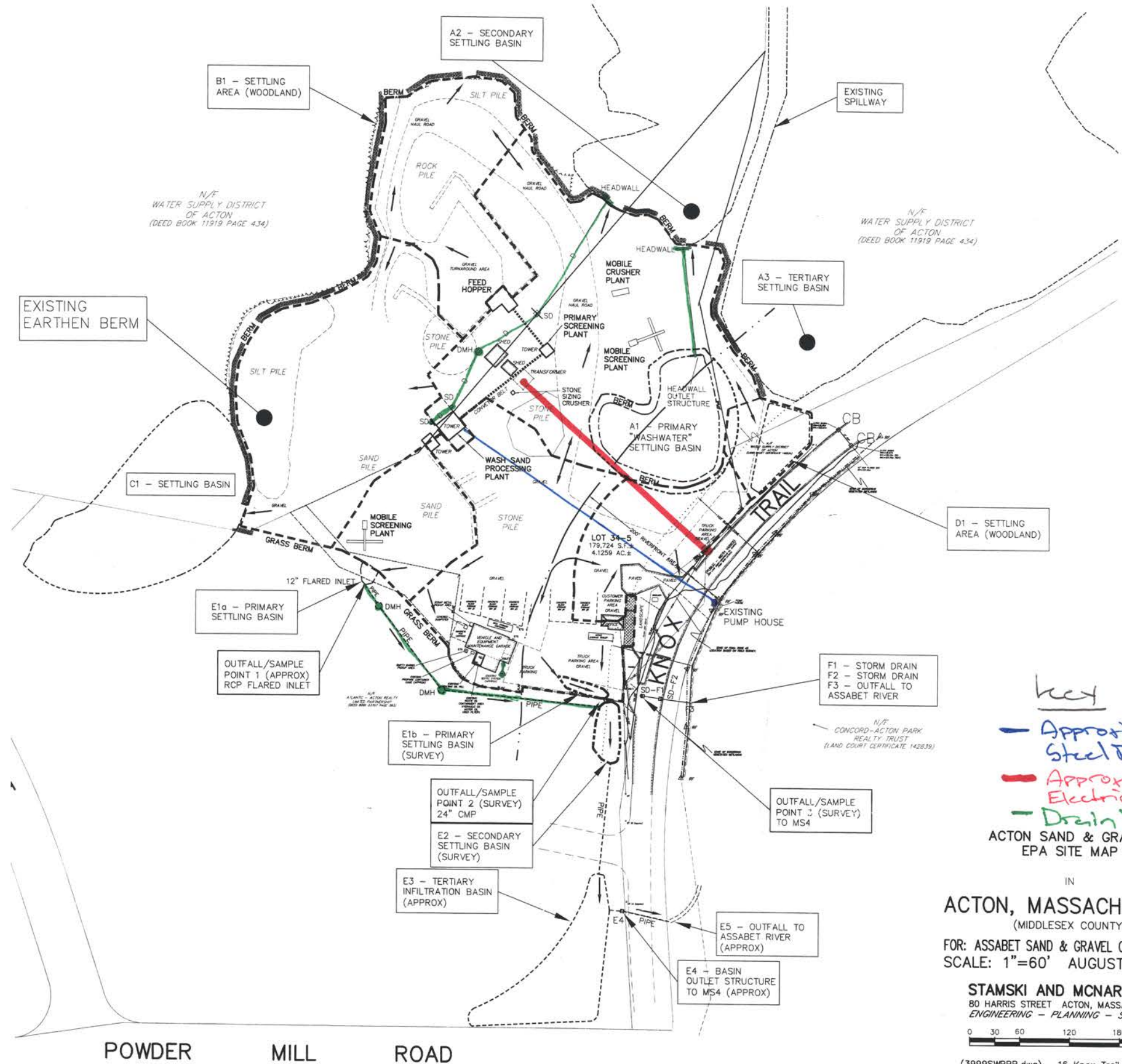

*key*

- Approximate Steel Pipe
- Approximate Electrical Conduit
- Drain Pipes

ACTON SAND & GRAVEL  
EPA SITE MAP

IN  
**ACTON, MASSACHUSETTS**  
(MIDDLESEX COUNTY)

FOR: ASSABET SAND & GRAVEL COMPANY, INC.  
SCALE: 1"=60' AUGUST 17, 2010

**STAMSKI AND MCNARY, INC.**  
80 HARRIS STREET ACTON, MASSACHUSETTS  
ENGINEERING - PLANNING - SURVEYING



NOTE: BASE MAP BY COL-EAST 1998. WELL LOCATIONS, W.R. GRACE PROPERTY LINE & MISC. SITE FEATURES COMPILED FROM INFORMATION PROVIDED BY CAMP DRESSER & MCKEE. SURROUNDING PROPERTY LINE LOCATIONS ARE FROM THE TOWN OF ACTON AND CONCORD ASSESSORS MAPS.

Lawsbrook Road Solar Site  
10/20/17

**EXPLANATION**

- W.R. GRACE PROPERTY BOUNDARY (APPROXIMATE)
- ACTON WATER DISTRICT PROPERTY BOUNDARY (APPROXIMATE)
- LINDE PROPERTY BOUNDARY (APPROXIMATE)
- MONITORING WELL (SINGLE OR CLUSTER)
- Observation Well*
- EXTRACTION WELL
- PUBLIC WATER SUPPLY WELL
- RIVER TRANSECT

- CURRENT GROUNDWATER SAMPLING PARAMETERS**
- D (91) VOC
  - SBR (56) VOC
  - LOCATION IN UNCONSOLIDATED DEPOSITS
  - LOCATION IN BEDROCK
  - SAMPLED FOR VOLATILE ORGANIC COMPOUNDS
  - ELEVATION OF SCREEN BOTTOM
  - SPECIFIC WELL DESIGNATION SAMPLED
  - VOC+
  - VOC+
  - SAMPLED FOR VOC'S PLUS INORGANIC COMPOUNDS AND 1,4-DIOXANE

Approximate Location of water main

Approximate land for solar layout



TITLE: <b>CURRENT GROUNDWATER SAMPLING LOCATIONS</b>		APPROVED   AES DRAFTED   RMK PROJECT#   117-3008027 DATE   JULY 2010	FIGURE <b>6-1</b>
LOCATION: W.R. GRACE, ACTON, MASSACHUSETTS			

G:\W.R.G-ACTN\2010\06-10-NE-AREARPT\NE-GW-SAMP-08.DWG